

S5 & S6 SYSTEMS

All American Stages Quick Start Guide
for your All American Drinking Water System

USWaterTM
systems.com

S5 & S6 SYSTEMS

The US Water Systems All-American Reverse Osmosis system is a powerful and efficient way to ensure your drinking water is clean and safe. This system uses advanced filtration technology to remove impurities like dirt, chemicals, and contaminants, including those too small to see, like microplastics and certain chemicals linked to health risks.

ON THE BOX:

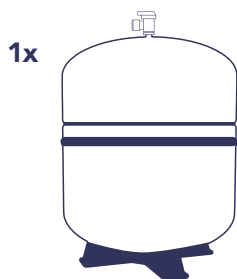

RO Module

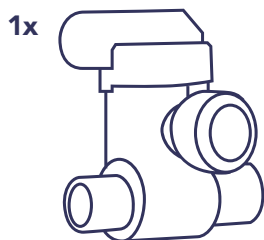

Feed Valve

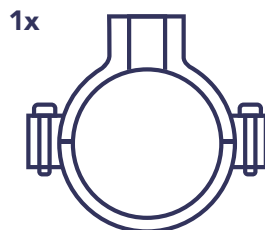

Drain Saddle

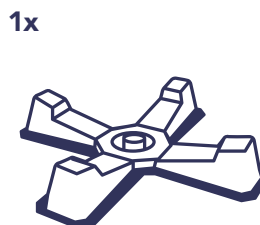

Tank and Stand



Sanitizer Kit

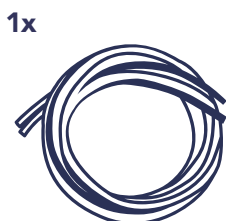

Tubing Bundle



Filter Wrench

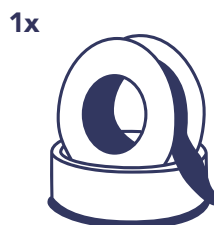

Teflon Tape

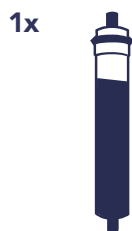

Sediment Filter

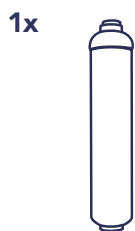

Chlorine Filter

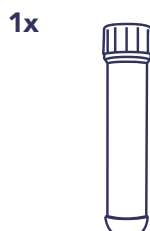

Chloramine Filter



Carbon Polishing Filter



Alkaline Livation Filter
(6-Stage Only)

USWater
systems.com

**All American Stages
Quick Start Guide**
for your All American
Drinking Water System

TOOLS REQUIRED:

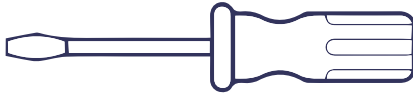

Phillips head and flat blade screwdrivers

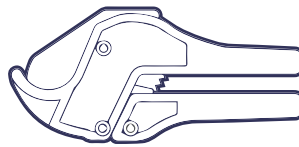

Adjustable Wrench

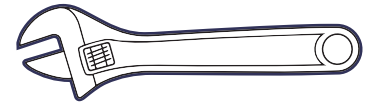

Adjustable Wrench

HOW TO QUICK CONNECT FITTINGS

Cut the Tube Square

It is essential that the outside diameter be free from score marks and that burrs and sharp edges be removed inserting the tube into the fitting. For soft, thin walled tubing, we recommend the use of tube inserts.

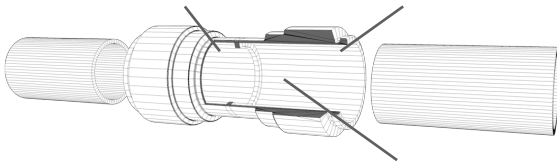

Insert Tube

The fittings will grip before as seal is formed. Ensure the tubing is pushed fully into the tube stop. fitting. For soft, thin walled tubing, we recommend the use of tube inserts.

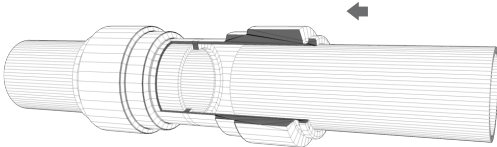

Push to the Tube Stop

Push the tubing into the fitting, up to the tube stop. The collet (gripper) has Stainless steel teeth which hold the tubing firmly in position while the O-ring provides a permanent, leak proof seal.

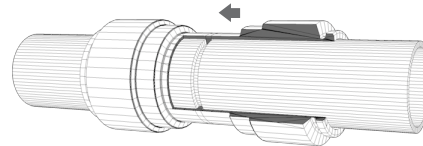

Pull to Check Secure

Pull on the tubing to check that it is secure. It is a good practice to test the system prior to leaving the site and/or before use.

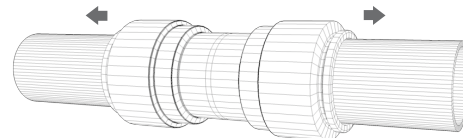

Disconnecting

Push in Collet and Remove Tubing. To disconnect, ensure the system is depressurized before removing the tube, Push in the collet squarely against the face of the fitting. With the collet held in this position, the tube can be removed, The fitting can be re-used.

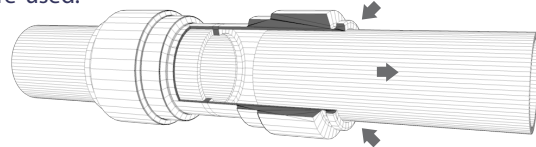

All American 5 Stage

REVERSE OSMOSIS

INSTALLATION DIAGRAM

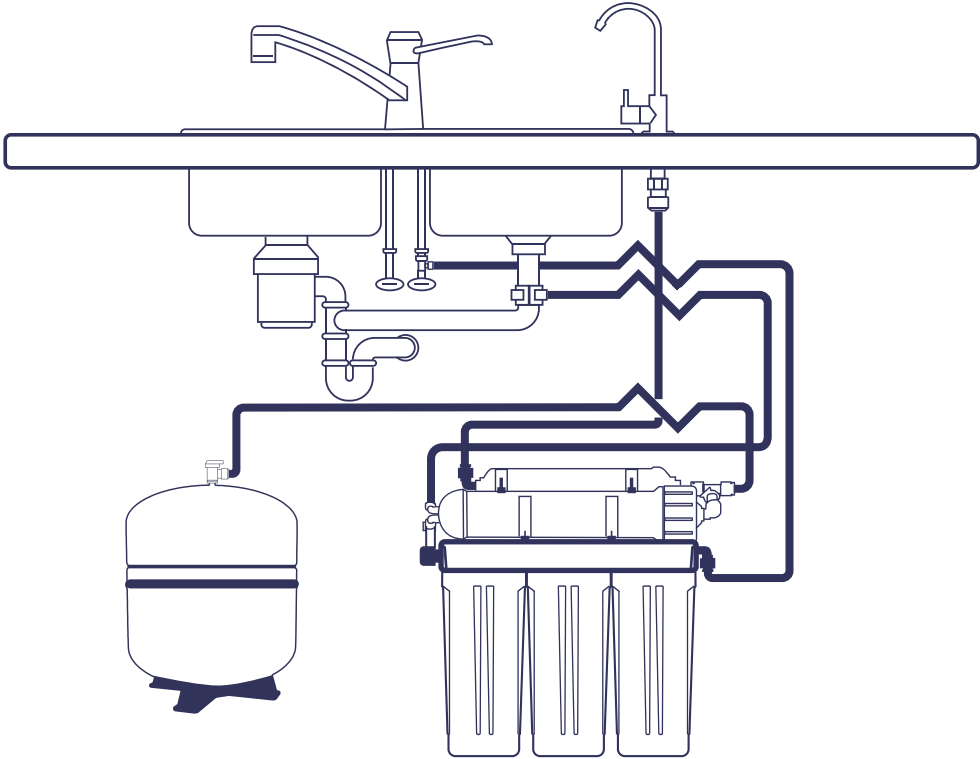

All American 6 Stage

REVERSE OSMOSIS

INSTALLATION DIAGRAM

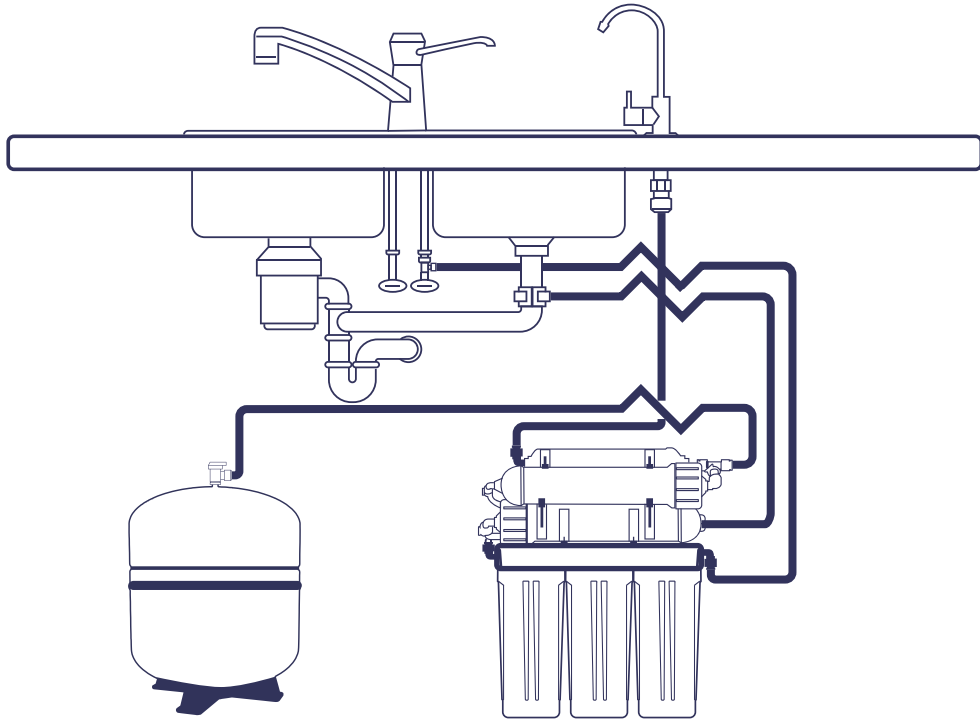

All American 6 Stage

REVERSE OSMOSIS

INSTALLATION DIAGRAM

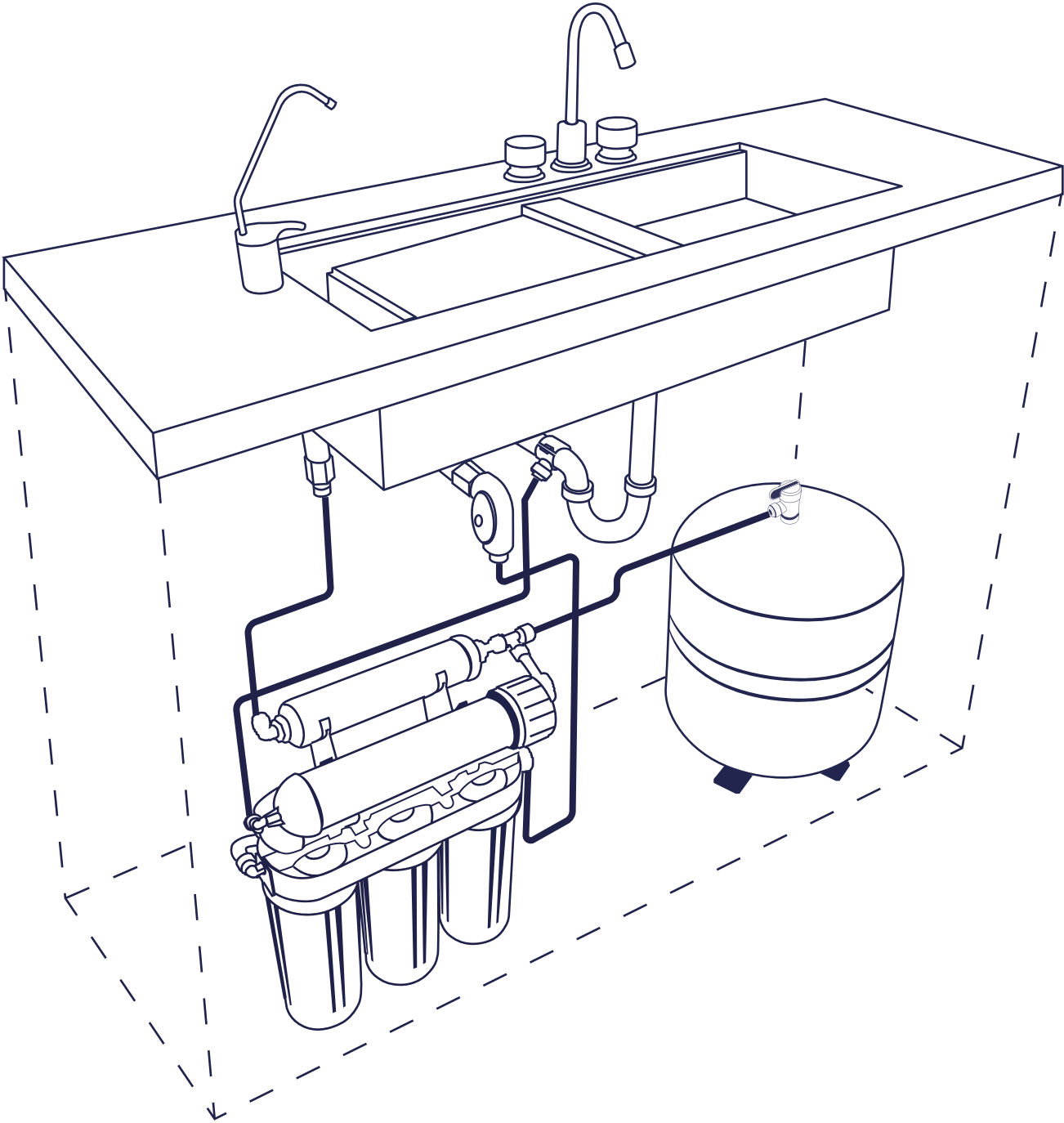

Installation Location

Install the RO system in a space like under a sink, in a heated basement, or another suitable area. Ensure the location stays above freezing to avoid damage. Also, consider connecting it to an ice maker or fridge dispenser.

Components and Placement

Faucet - Install near the sink for easy access to drinking and cooking water. Requires a 2" flat surface for mounting, unless there's an existing hole for a second faucet.

Storage Tank - Place within ten feet of the RO module for convenience. Suitable locations include under the sink or in a nearby cabinet. Ensure the shelf is sturdy as a full tank can weigh over thirty pounds.

RO Module: Can be mounted on either side of the sink, inside a cabinet, or in a heated basement, close to a potable, cold water line and a sanitary drain.

Feed Water Connection: Use an angle stop feed water valve installed in the cold water line between the sink's shut-off valve and the faucet tubing. Only connect to a potable, cold water supply.

Drain Connection: Install the drain saddle valve above the trap and on either the vertical or horizontal tailpiece. Avoid placement near a garbage disposal to prevent clogging of the wastewater line.

Note: Local plumbing codes may require air gaps. Check with your local municipality for compliance.

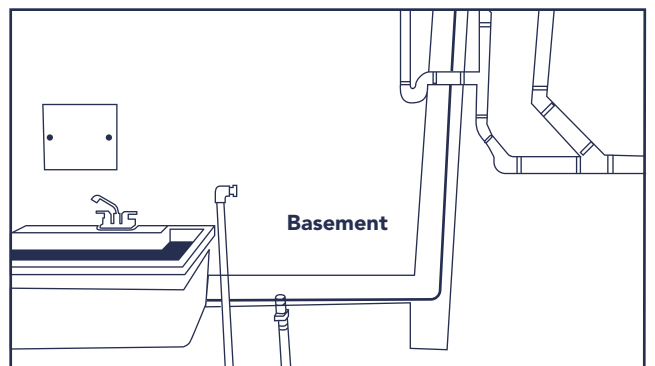
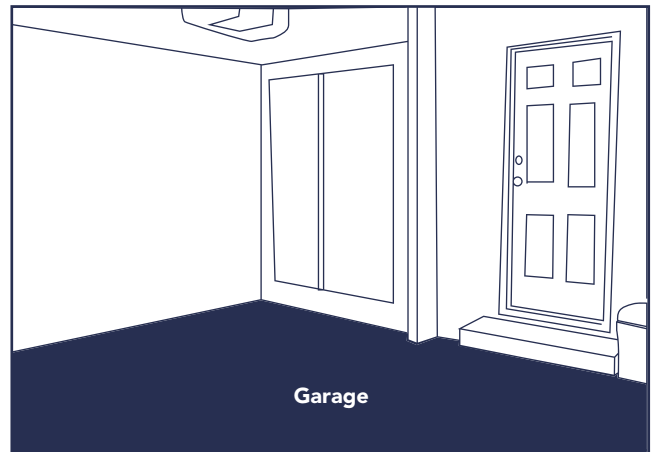
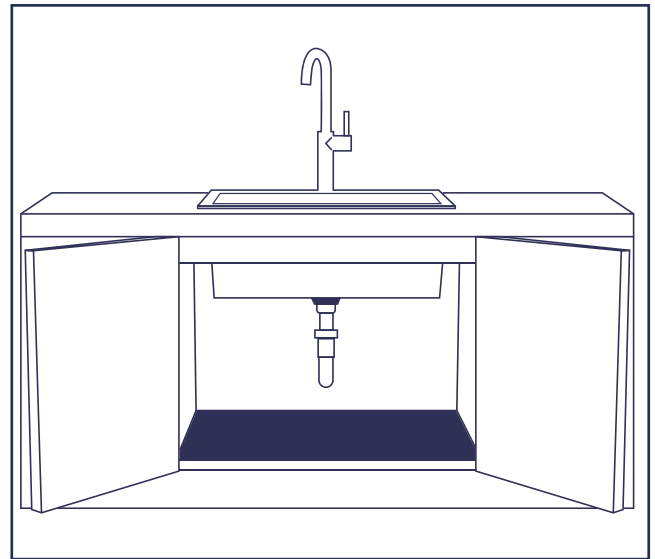

Faucet Installation

Prepare the Hole:

If there's no existing hole, drill a 1" hole at the desired faucet spot. Position it to allow the spout to swivel freely.

- 1 Unpack and Prep Faucet:**
Remove the faucet from its package. Take off the tightening nut from its stem.
- 2 Insert Faucet:**
Place the faucet stem into the hole, ensuring the accompanying rubber gasket is flush with the sink surface for a proper seal.
- 3 Secure Faucet Underneath:**
Reattach and tighten the nut under the sink to secure the faucet. You may need someone to hold the faucet steady from above while you do this.
- 4 Connect Water Line:**
Push the blue tube into the faucet's connector. Leave the other end disconnected for now; it will be attached later in the setup.

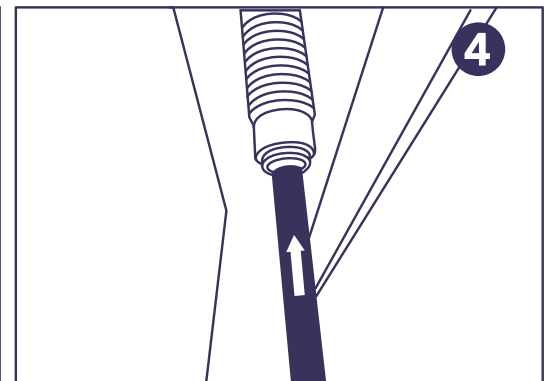
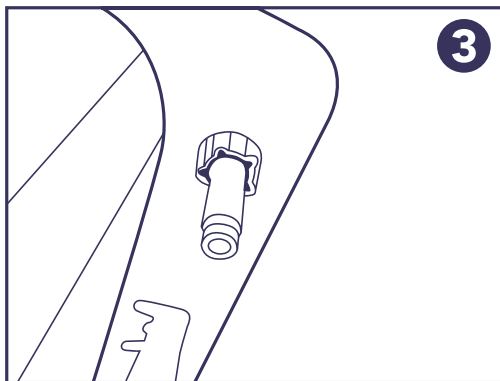
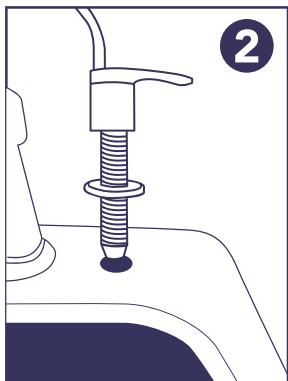
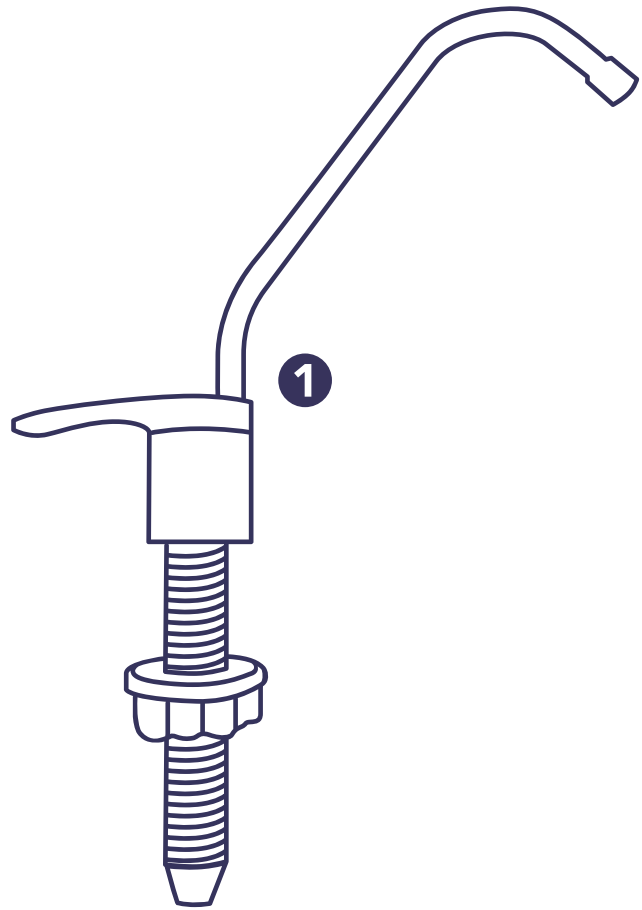

Feed Water Valve and Tubing

Shut Off Water & Prep Area:

Turn off the cold water supply. Open the sink faucet to release any remaining water.

Disconnect Existing Lines:

Remove the 'Whip hose' or supply line tubing from the sink's cold water shutoff valve, catching any drips with a towel.

Install Angle Stop Valve:

Install the new angle stop valve onto the sink faucet shutoff valve and tighten securely. It's designed to swivel, so don't worry about its initial position.

Test for Leaks:

Ensure the blue handle on the angle stop valve is closed. Open the sink's shutoff valve to check the new connections for any leaks and address them if needed.

Attach Tubing:

Connect the orange tubing to the angle stop valve without tightening fully—this will be secured later in the installation process.

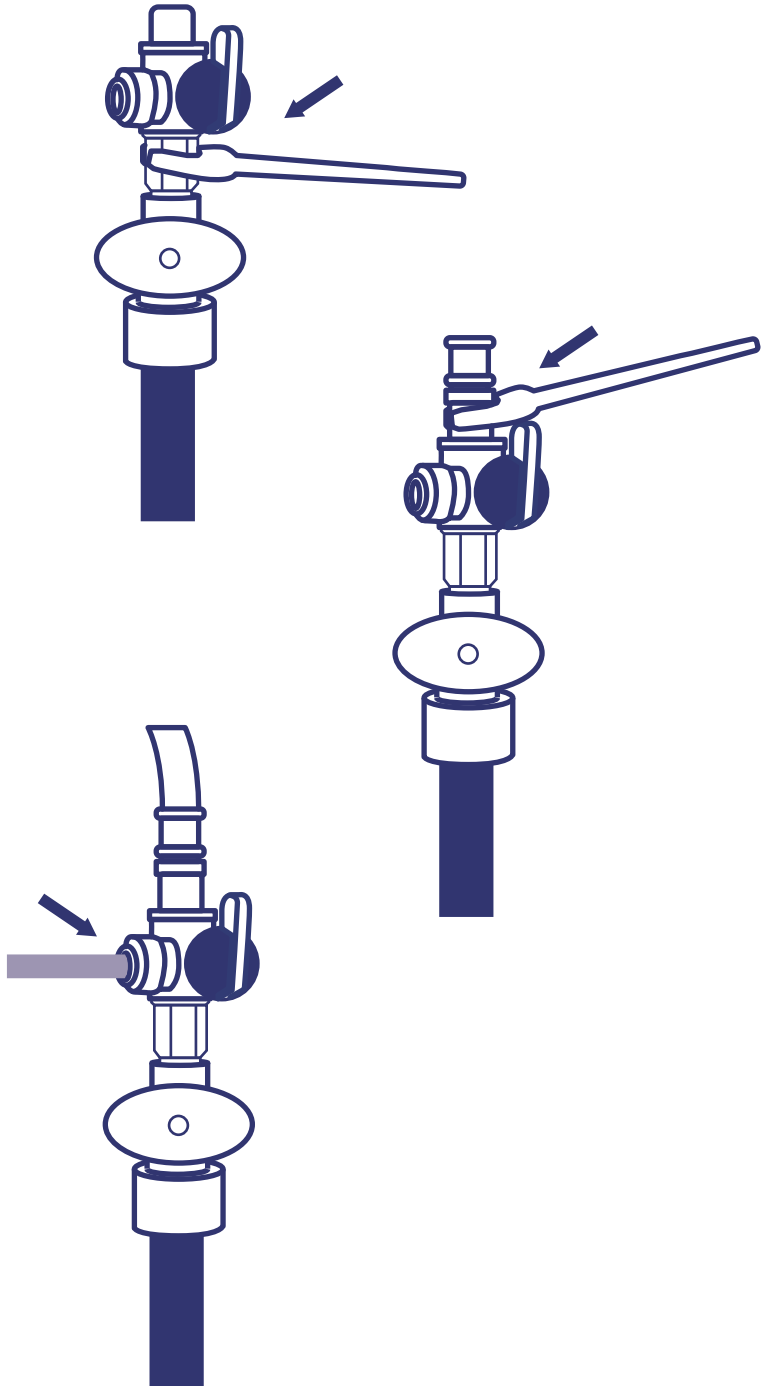

Tank Installation

Prepare Fitting:

Wrap Teflon tape around tank outlet threads (3-4 wraps).

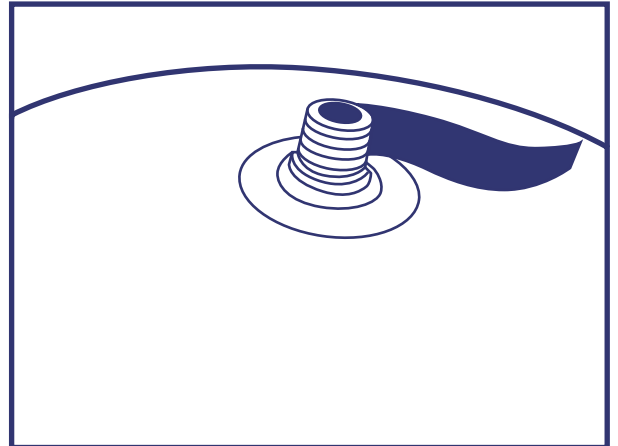

Install Valve:

Screw tank valve on counter-clockwise; usually, hand-tight is okay, but check if more tightening is needed.

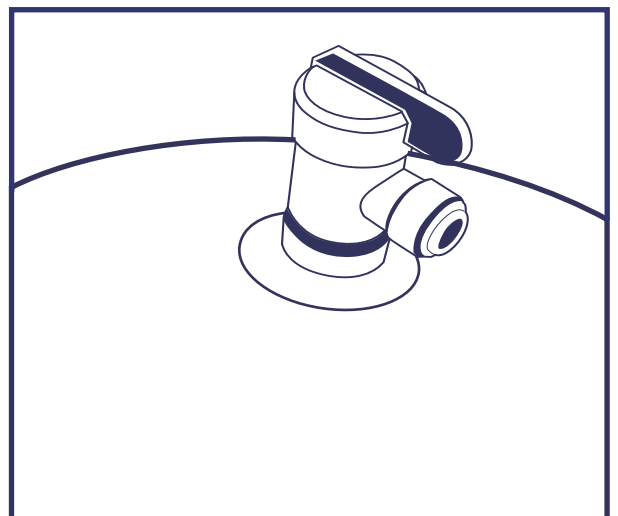

Attach Tubing:

Attach green 3/8" tubing to valve. Leave other end free; it will be connected during final steps of installation.

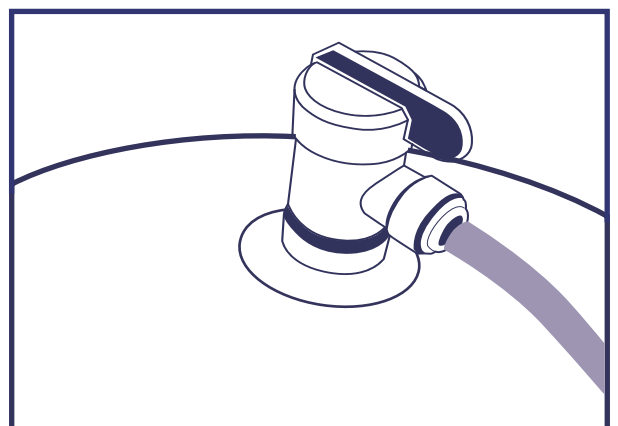

RO Module Installation

Mount the RO Unit to the sink cabinet sidewall.
Place the unit towards the front and, tank at the back.

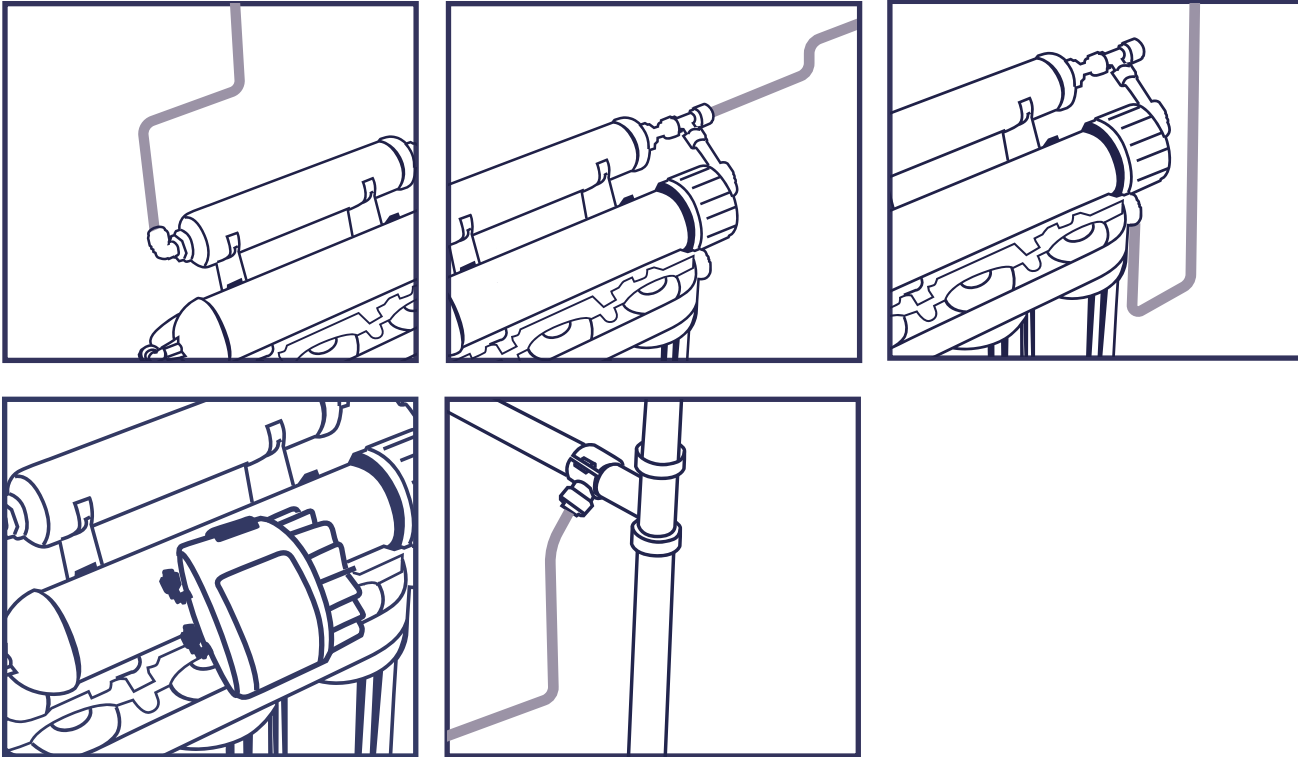

Final Tubing Connections:

Cut tubes to length with clean square cuts.
Avoid any sharp bends in the tubing.

1. Connect blue tube from the faucet to the RO unit's post-carbon filter outlet.
2. Ensure the storage tank's shut-off valve is closed before connecting the green tubing from the tank to the RO unit's post-carbon filter inlet. Leave the tank valve closed.
3. Attach the orange tubing from the angle stop supply valve to the RO unit at the sediment filter inlet on the far right.
4. Connect the 1/4" black tubing from the RO unit to the drain saddle.

Permeate Pump (Optional) Installation:

If present, secure the permeate pump to the membrane housing with the bracket provided.

1. Connect tubing as labeled on the pump and follow the flow diagram.
2. Make the BRINE OUT connection as directed in the next step(s).
3. If a permeate pump is installed, connect tubing from the "Brine Out" port to the permeate pump and then to the drain saddle.